

### ARCHITECTURAL PASSAGE SET

#### Product codes:

8099 | 8109 | 8128 | 8132 | 8137 | 8142

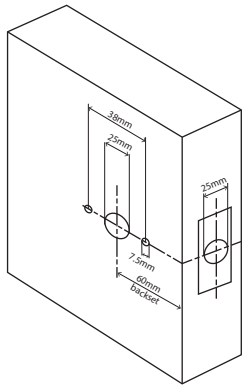

1. Measure the door thickness and mark the centre at the desired height for the latch.
2. Drill a 25mm (1") diameter hole through the door edge to a depth of at least 90mm. Ensure this hole is square to the door.
3. Mark the face of the door each side for drilling a 25mm diameter spindle hole. The centre of the spindle hole will need to be 60mm from the door edge (backset). For clean cut-outs, drill from both sides, meeting in the middle of the door. Mark and drill two 6mm screw holes at 19mm to the left and to the right of the centre of the spindle hole. Enlarge the first 5mm of these holes to 7.5mm to fit the lugs on the plates.

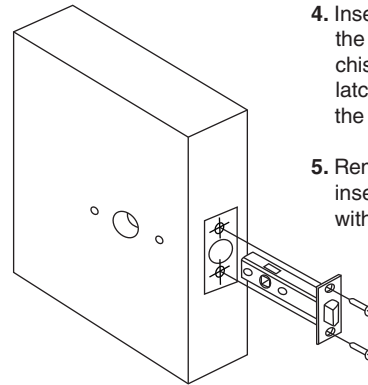

4. Insert the latch, scribe around the faceplate, remove, then chisel out recess to enable the latch faceplate to sit flush with the door edge.
5. Remove any loose saw dust, insert the latch and secure it with the wood screws provided.

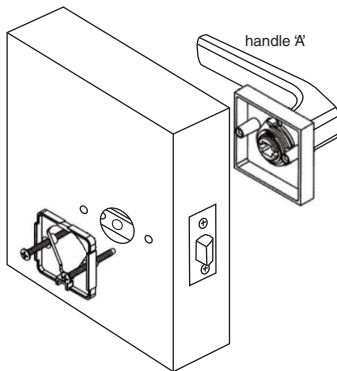
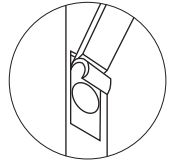

6. Loosen the grub screw on the side of the rose of the lever with the mounting plate (handle 'B') and remove the mounting plate.
7. Fit the mounting plate onto the face of the door by inserting the long through fixing bolts into the face of the mounting plate at two horizontal positions. Pass the bolts through the latch body and fix into the lever of handle 'A' on the opposite side of the door. Trim the bolts to the correct length if necessary.

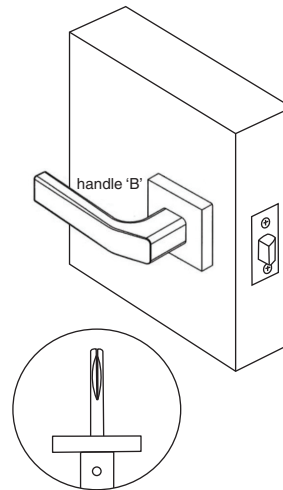

8. Insert the spindle into the latch and into handle 'A'. Ensure the grooved side of the spindle will align with the grub screws on the handles. Slide handle 'B' over the spindle onto the mounting plate, press against the door and tighten the grub screw on the side of the rose to the mounting plate. Tighten the grub screws on the side of the levers onto the spindle for each side of the door.

*Note: The grub screws may need a re-tighten after a bedding-in period. We recommend medium strength thread-lock to be used, Windsor code:1276*

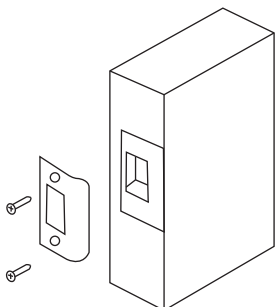

9. Close the door against the frame and mark the latch position for fitting of the striker.
10. Router or chisel so the striker fits flush, allowing for the plastic dustbox behind the striker.
11. Secure the striker with the wood screws provided. Test the door and if necessary, adjust the striker anti-rattle tab to take up any rattle.